



Revisione	Data	Oggetto modifiche	Eseguito	Verificato	Approvato
<div>REALIZZAZIONE DEL POLO INFANZIA</div> <div>Via Villagrappa - San Mauro Pascoli (FC)</div>					
<div><div><div><div>Finanziato dall'Unione europea</div><div>NextGenerationEU</div></div><div></div></div><div>“Opera finanziata dall’Unione Europea – NextGenerationEU - Fondi PNRR – M4C1 – 1.1 “PIANI PER ASILI NIDO E SCUOLE DELL’INFANZIA E SERVIZI DI EDUCAZIONE E CURA PER LA PRIMA INFANZIA”</div><div>Comune di San Mauro Pascoli. Provincia Forlì - Cesena</div></div>					
<div>Progetto DEFINITIVO di cui all'art.24 del D.P.R. 207/2010 per la realizzazione di Nuovo Polo Infanzia in Via Villagrappa</div> <div>CUP. G85E21000090006</div>					
		<div>progetto:</div> <div>TULLIO ZINI</div> <div>ARCHITETTO</div> <div>via Archirola, 165 - 41124 Modena</div> <div>tel.059-391050</div> <div>tulliozini@tulliozini.it</div> <div>ZPZ PARTNERS</div> <div>via Archirola, 165 - 41124 Modena</div> <div>tel.059-391050</div> <div>mail@zpzpartners.it</div> <div>www.zpzpartners.it</div> <div>INTeGRA Professionisti Associati</div> <div>Via Alberto Brasili, 91 - 41122 Modena (MO)</div> <div>tel.059-4394770</div> <div>info@webintegra.it</div> <div>Studio Associato Energia</div> <div>Via Guglielmo Marconi, 30/3 - 48018 Faenza (RA)</div> <div>tel. 0546-668163</div> <div>energia@energia.ra.it</div>	<div>timbro e firma</div> <div></div> <div>timbro e firma</div> <div></div>	<div>progetto:</div> <div>architetonico</div> <div>arch. Tullio Zini</div> <div>arch. Michele Zini</div> <div>arch. Claudia Zoboli</div> <div>arch. Sara Michelini</div> <div>geom. Maurizio Forghieri</div> <div>arch. Oliver Forghieri</div> <div>computi</div> <div>strutture</div> <div>ing. Filippo Naldi</div> <div>ing. Daniele Cavazzani</div> <div>impianti meccanici, elettrici, energetici, antincendio</div> <div>p.i. Andrea Montuschi</div> <div>ing. Pietro Collina</div> <div>p.i. Piero Ponti</div> <div>sicurezza</div> <div>ing. Filippo Naldi</div> <div>acustica</div> <div>ing. Emanuele Morlini</div> <div>DNSH</div> <div>ing. Francesco Bonacini</div> <div>indagine geologica</div> <div>Geo Group srl</div>	
titolo			scala	tavola	data
Sanitari			1:50	ARC 16.2	data della firma digitale

SERVIZI IGIENICI BAMBINI



h sanitari 35
h lavabo 55

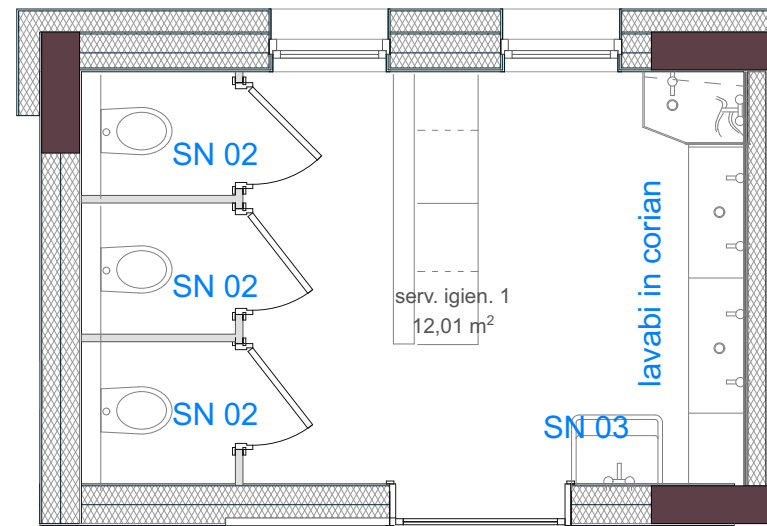
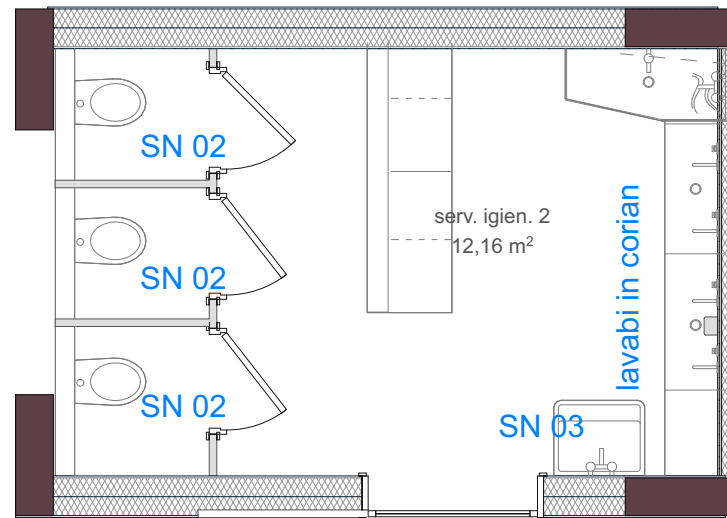

h sanitari 35
h lavabo 55

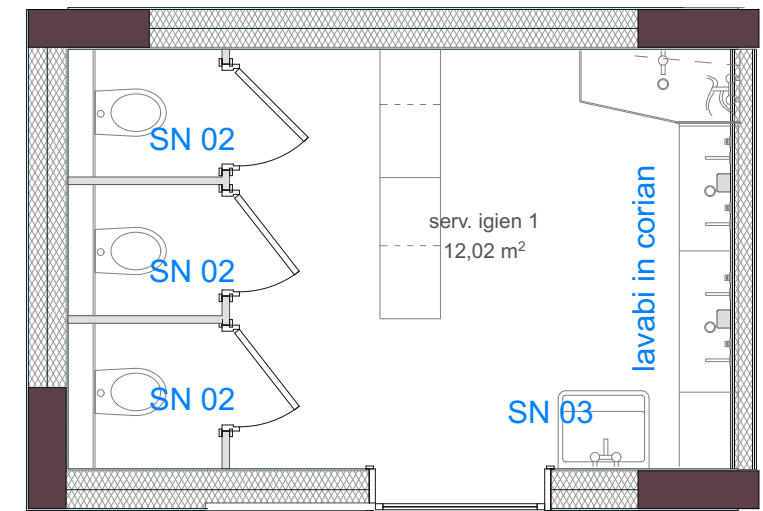

h sanitari 35
h lavabo 55

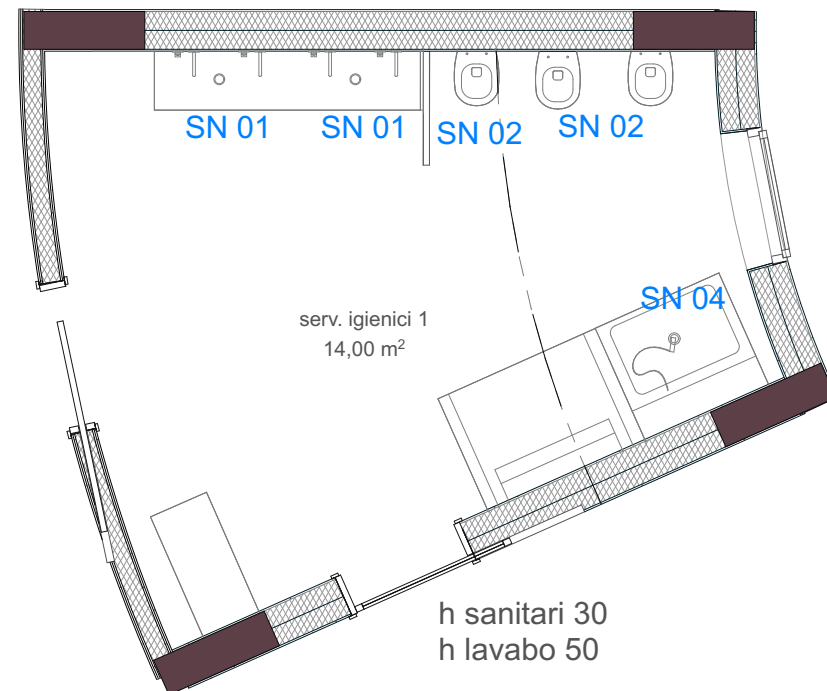

h sanitari 30
h lavabo 50

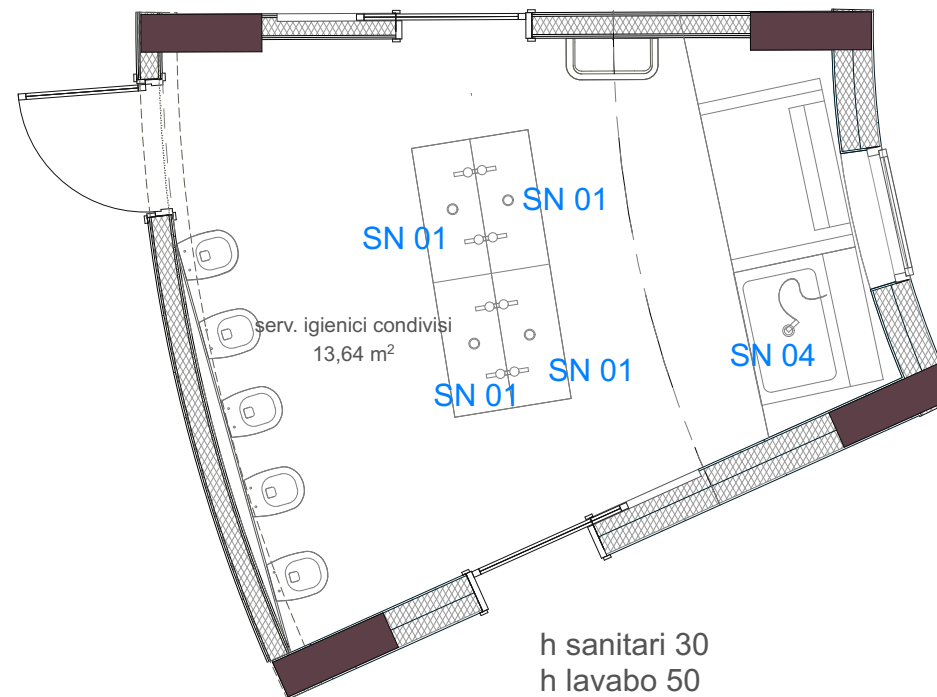

h sanitari 30
h lavabo 50

lavabi in corian in alternativa 3 lavabi a canali 90x45

SN 01 Lavabo a canale tipo Pozzi Ginori serie Elleboro 90x45

SN 02 Vaso bimbi tipo Bucket Hung wc-Kids di Scarabeo

SN 03 Pilozzo lavanderia tipo Deghi

SN 04 Vaschetta igienica tipo Foster

Miscelatore incasso per lavabi a canale con bocca

Miscelatore pilozzo tipo Foster serie Camillo
satinato - 8467 100

Placchetta cromo opaco tipo Geberit

Sifone cromato tipo Geberit

Piletta circolare

SERVIZI IGIENICI ADULTI

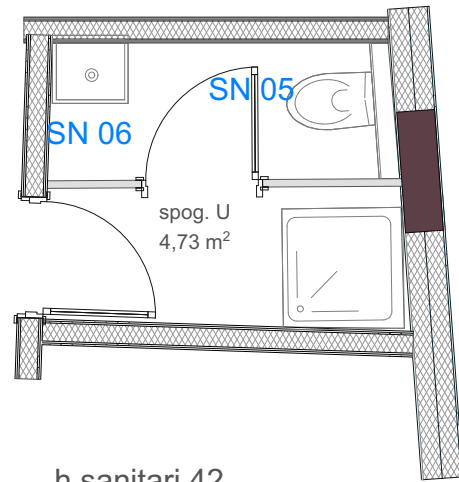

h sanitari 42
h lavabo 88

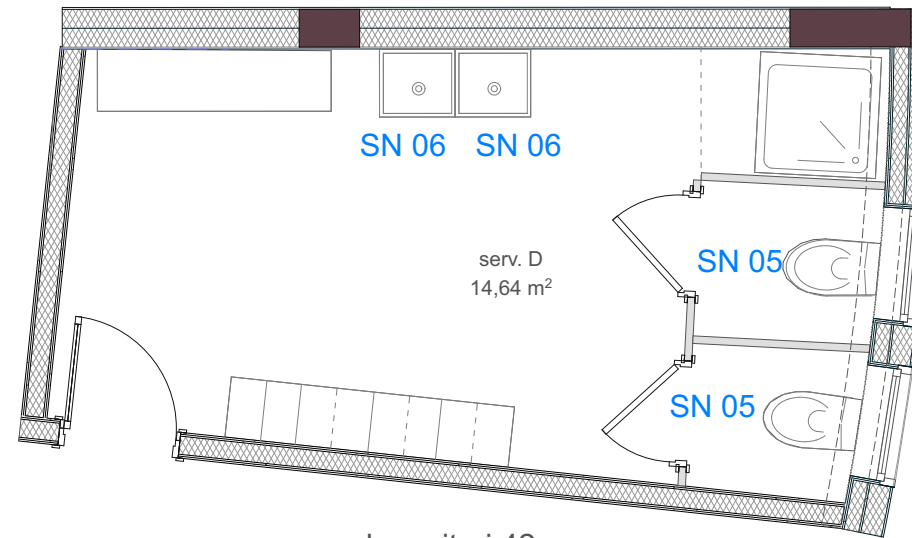

h sanitari 42
h lavabo 88

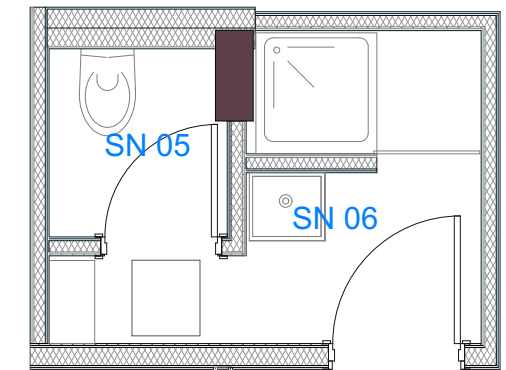

h sanitari 42
h lavabo 88

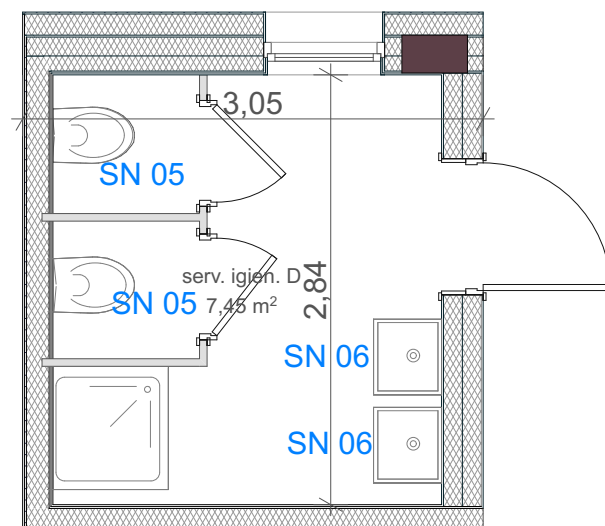

h sanitari 42
h lavabo 88

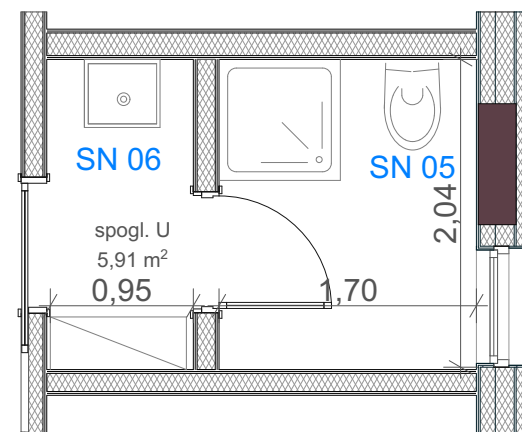

h sanitari 42
h lavabo 88

SN 05 Vaso tipo Kerasan serie Flo

SN 06 Lavabo sospeso tipo Kerasan serie Cento 60x45 cm

Miscelatore lavabo tipo Fonte Light 070

Miscelatore bidet tipo Paffoni Fonte Light 135

Piatto doccia con termostatico tipo Paffoni KIT LIQ018

Miscelatore lavabo per disabili tipo Paffoni RED 300

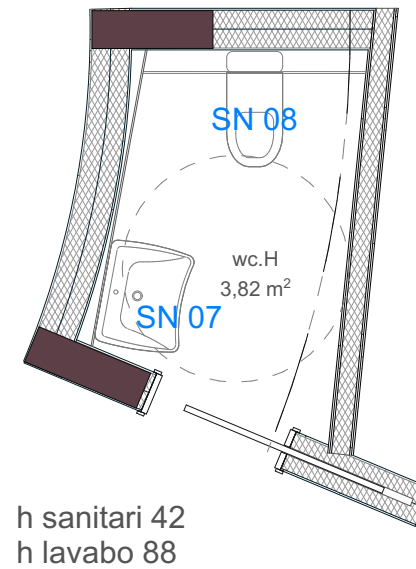
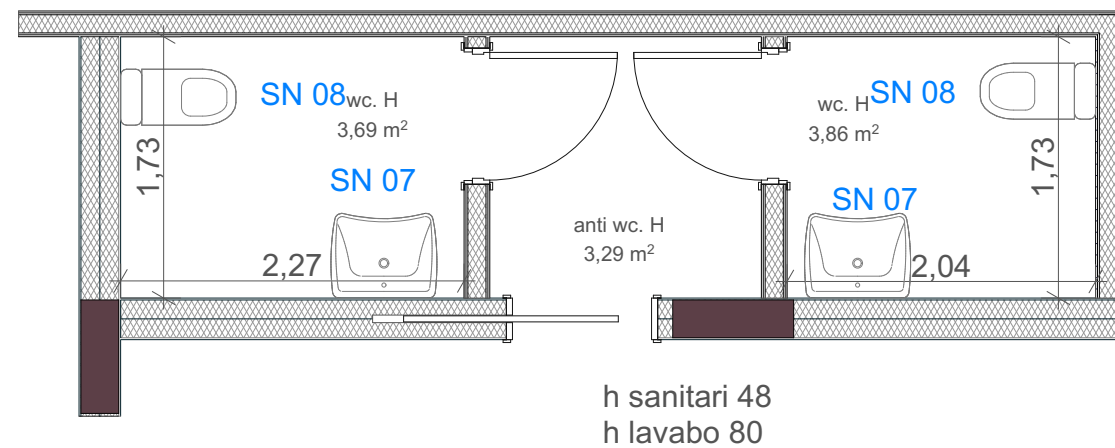

SN 07 Lavabo sospeso disabili Ideal standard serie Contour 21

SN 08 Wc sospeso disabili Ideal standard serie Contour 21

LAVANDERIA

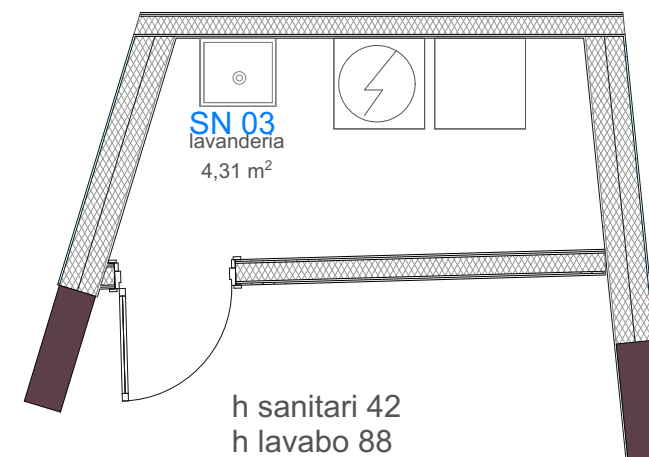
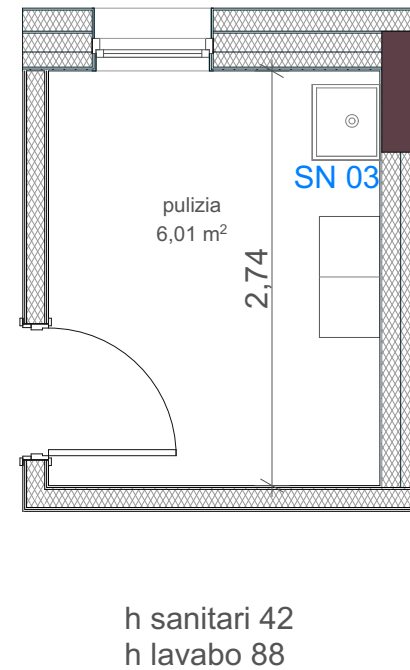
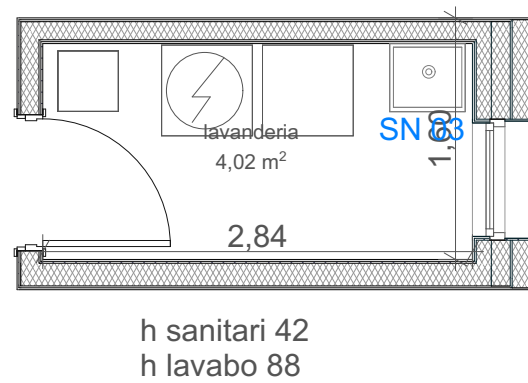

SN 03 Pilozzo lavanderia tipo Deghi

Miscelatore pilozzo tipo Foster serie Camillo
satinato - 8467 100